

22 Flush pull - rectangle

- Low profile makes this pull ideal for louvered, bi-folding or wardrobe doors.
- Extra deep recess and reverse tapered grip provide for ease of pulling and gripping.
- Packaged with fasteners for wood applications

Certifications

- Meets ANSI/BHMA 156.9 B22201 and A156.14 D2781

Material substrate

- Made from wrought brass.

Finishes

BHMA	Description	Substrate	Finish
605	Bright brass	Brass	B3
609	Satin brass	Brass	B5
613	Oil rubbed bronze	Brass	B10B
619	Satin nickel	Brass	B15
622	Matte black	Brass	B-BLK
625	Bright chrome	Brass	B26
626	Satin chrome	Brass	B26D
—	Aged bronze	Brass	B-643e/716

Dimensions

- 1-5/16" High x 3-1/8" Wide x 7/16" Deep

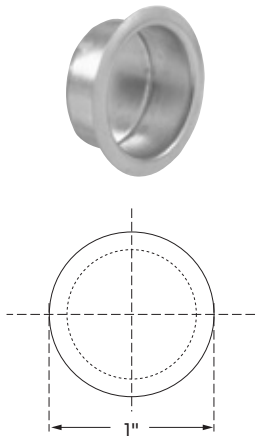

218 Flush pull - small circle

- Ideal for use on sliding doors.
- Easy installation.
- Packaged 4 per bag

Certifications

- Meets ANSI/BHMA 156.9 B22201 and A156.14 D2781

Material substrate

- Made from wrought brass.

Finishes

BHMA	Description	Substrate	Finish
605	Bright brass	Brass	B3
609	Satin brass	Brass	B5
612	Satin bronze	Brass	B10
613	Oil rubbed bronze	Brass	B10B
619	Satin nickel	Brass	B15
622	Matte black	Brass	B-BLK
625	Bright chrome	Brass	B26
626	Satin chrome	Brass	B26D
—	Aged bronze	Brass	B-643e/716

Dimensions

- Inside cup diameter: 3/4"
- Overall diameter: 1"
- Depth: 3/8"

A
Hinges & pivots

B57
Pulls & plates

C
Flush bolts & coordinators

D
Latches, catches & bolts

E
Stops

F
Exterior hardware

G
Miscellaneous hardware